

Premier Sales Group, Inc. a licensed real estate broker, is the exclusive sales and marketing agent for Lionheart Capital. The Riz-Carlton Residences, Miami Beach are not owned, developed or sold by The Riz-Carlton Hotel Company, L.L.C. 4701 North Meridian LLC uses The Riz-Carlton marks under a license from The Riz-Carlton Hotel Company, L.L.C. OBTAIN THE PROPERTY REPORT REQUIRED BY FEDERAL LAW AND READ IT BEFORE SIGNING ANYTHING. NO FEDERAL AGENCY HAS JUDGED THE MERITS OR VALUE, IF ANY, OF THIS PROPERTY. ORAL REPRESENTATIONS CANNOT BE RELIED UPON AS CORRECTLY STATING THE REPRESENTATIONS OF THE DEVELOPER. FOR CORRECT REPRESENTATIONS, REFERENCE SHOULD BE MADE TO THE DOCUMENTS REQUIRED BY SECTION 718.503, FLORIDA STATUTES, TO BE FURNISHED BY A DEVELOPER TO A BUYER OR LESSEE. This offering is made only by the prospectus for the condominium and no statement should be relied upon if not made in the prospectus. Prices, plans and specifications are subject to change without notice. Stated dimensions are measured to the exterior boundaries of the exterior walls and the centerline of interior demising walls and in fact vary from the dimensions that would be determined by using the description and definition of the "Unit" set forth in the Declaration (which generally only includes the interior airspace between the perimeter walls and excludes interior structural components). For the precise Unit boundaries, please refer to the Declaration. Note that measurements of rooms set forth on this floor plan are generally taken at the greatest points of each given room (as if the room were a perfect rectangle), without regard for any cutouts. Accordingly, the area of the actual room will typically be smaller than the product obtained by multiplying the stated length times width. All dimensions are approximate and may vary with actual construction, and all floor plans and development plans are subject to change. The seller reserves the absolute right, in its sole judgment and discretion, to substitute appliances, materials, fixtures, and equipment of equal or great quality or value for those specified.

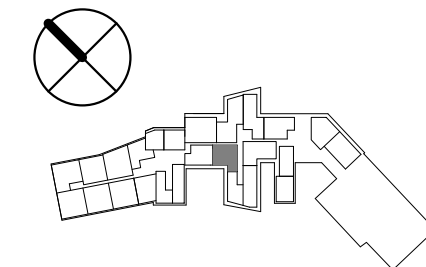

Key Plan

RESIDENCE TYPE C2
 LIVING AREA..... 2,627 SQ.FT
 TERRACE..... 234 SQ.FT
 TOTAL AREA.....2,861 SQ.FT
 TOTAL AREA.....265 SQ.M

RESIDENCE DETAILS
 2 BEDROOM / 2.5 BATH + MEDIA RM.
 RESIDENCE 213: 12'-0" CEILING HEIGHT
 RESIDENCE 313: 12'-0" CEILING HEIGHT
 RESIDENCE 413: 9'-3" CEILING HEIGHT

