



# THE MANSIONS AT ACQUALINA

*Private Residences*

## PALAZZO DI SABBIA

5 BEDROOMS | 7.5 BATHS | PRIVATE POOL | PRIVATE SPA | SUMMER KITCHEN  
GRAND SALON | FORMAL DINING ROOM | FAMILY ROOM  
KITCHEN | BREAKFAST ROOM | BUTLER ROOM

ENCLOSED AREA: 8,488 SQ. FT. | 788.5 SQ. METERS  
TERRACE AREA: 2,428 SQ. FT. | 225.5 SQ. METERS  
TOTAL AREA: 10,916 SQ. FT. | 1,014.1 SQ. METERS

PAINT TO PAINT  
RESIDENCE: 7,022 SQ. FT. | 652.3 SQ. METERS

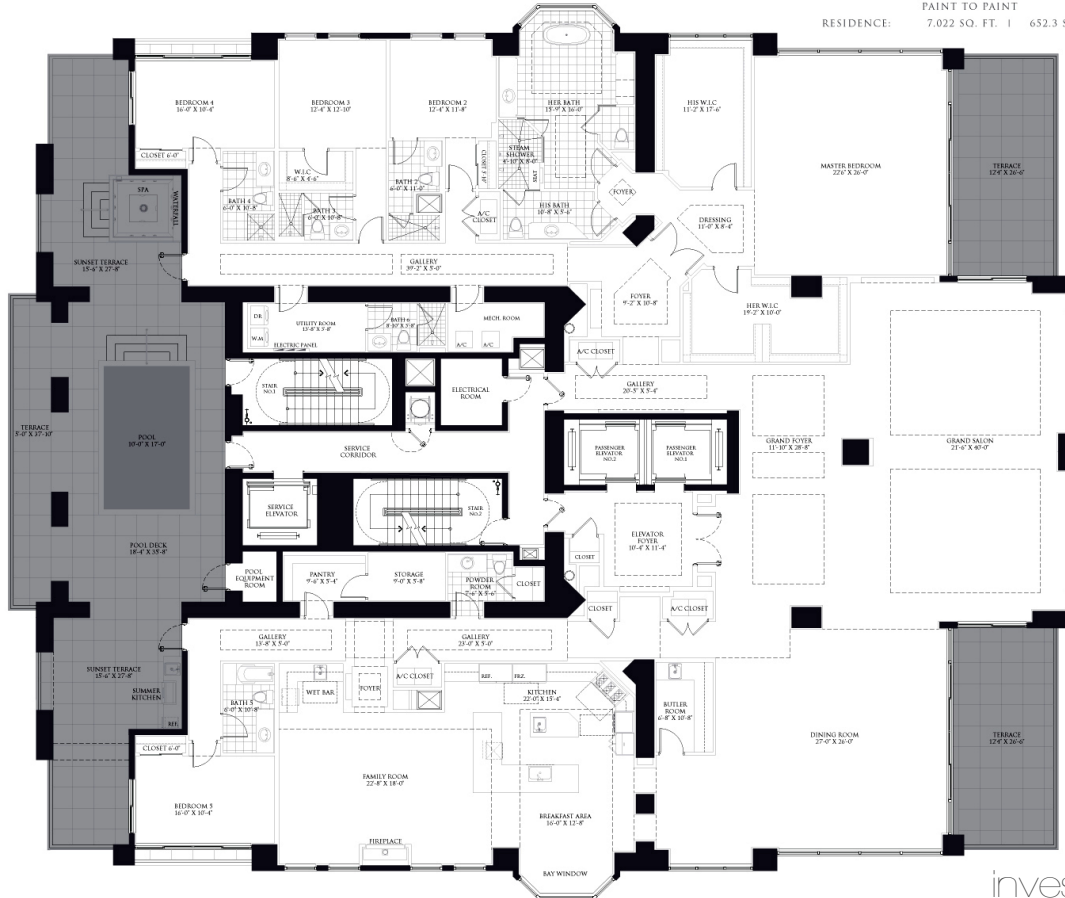

investinmiami.com



ITEMS DEPICTED ON THIS FLOOR PLAN ARE CONCEPTUAL ONLY AND ARE FOR THE CONVENIENCE OF REFERENCE. THEY SHOULD NOT BE RELIED UPON AS REPRESENTATIONS, EXPRESS OR IMPLIED, OF THE FINAL DETAILS OF THE UNIT. THE DEVELOPER EXPRESSLY RESERVES THE RIGHT TO MAKE MODIFICATIONS, REVISIONS AND CHANGES IT DEEMS DESIRABLE IN ITS SOLE AND ABSOLUTE DISCRETION. ALL DIMENSIONS OF APPLIANCES, COUNTERTOPS, SINKS, FLOOR COVERINGS AND OTHER MATTERS OF DETAIL ARE CONCEPTUAL ONLY AND ARE NOT NECESSARILY INCLUDED IN EACH UNIT OR, IF INCLUDED, ARE NOT NECESSARILY INTENDED TO BE OF THE SIZE, MAKE OR LOCATION INDICATED. CONVERT FROM METRIC MEASUREMENTS AND THE PROPORTIONS OF THE ITEMS INCLUDED WITH THE UNIT. DIMENSIONS AND SQUARE FOOTAGE ARE APPROXIMATE AND SUBJECT TO CHANGE IN ACCORDANCE WITH THE PURCHASE AGREEMENT AND MAY VARY WITH ACTUAL CONSTRUCTION. GIVEN THE NATURE OF CONDOMINIUM OWNERSHIP, THE UNIT BOUNDARIES ARE PRECISELY DEFINED IN SUCH A MANNER SO THAT ALL COMPONENTS OF THE BUILDING WHICH ARE OR ARE POTENTIALLY UTILIZED EITHER BY OTHER UNITS OR THE COMMON ELEMENTS ARE EXCLUDED FROM THE UNIT. THIS WOULD INCLUDE, FOR INSTANCE, ALL STRUCTURAL WALLS, COLUMNS, ETC. AND ESSENTIALLY LIMITS THE UNIT BOUNDARIES TO THE INTERIOR SURFACE BETWEEN THE PREMIER WALLS AND INCLUDES ALL INTERIOR STRUCTURAL COMPONENTS. FOR THE RESIDENT UNIT BOUNDARIES, SEE SECTION 2.3 OF THE DECLARATION. FOR YOUR REFERENCE, THE AREA OF THE UNIT DETERMINED IN ACCORDANCE WITH THESE CUSTOMARY UNIT BOUNDARIES IS 7,022 SQUARE FEET (LARGELY LABELED AS "TYPICAL AREA"). PLEASE NOTE THAT THE UNDERSTANDING OF OBTAINING THE BOUNDARIES ACTUALLY MAKES THE UNIT APPEAR TO BE SMALLER THAN IT ACTUALLY WOULD BE IF STANDARD ARCHITECTURAL MEASURING TECHNIQUES WERE USED. TYPICAL APARTMENTS ARE MEASURED TO THE INTERIOR BOUNDARIES OF THE OUTSIDE WALLS AND TO THE CENTERLINE OF OUTSIDE EXISTING WALLS WITHOUT EXCLUDING AREAS THAT MAY BE OCCUPIED BY COLUMNS OR OTHER STRUCTURAL COMPONENTS. THE AREA IS CALCULATED BASED UPON STANDARD ARCHITECTURAL MEASURING TECHNIQUES. IT ALSO SET FORTH HEREON (AND LABELED AS "TYPICAL AREA"), THE TYPICAL AREA IS PROVIDED SOLELY TO ESTABLISH A FRAME OF REFERENCE AND IS NOT INTENDED TO SUGGEST THAT THE ACTUAL UNIT IS THAT SIZE. IN FACT, AS SET FORTH ABOVE, MANY OF THE COMPONENTS INCLUDED IN DETERMINING THE TYPICAL AREA, ARE COMMON ELEMENTS THAT ARE NOT EXCLUDED THEREOF.